



CABINET COMPONENTS & PARTS

Corona Millworks utilizes Cabinet Vision software and CNC equipment for cabinet component manufacturing. With this technology, we can efficiently produce cabinet parts with no standard or stock sizes. Every component is custom produced per-order and is shipped ready to assemble.

Our CNC capabilities allow us to precision machine a wide variety of cabinet components for the cabinet industry. Simply provide the dimensions, material specifications, and quantities. We'll handle the rest!

COMPONENT INFORMATION & GUIDELINES

CABINET CONSTRUCTION

1. All parts are 3/4" thick except back. The customer specifies materials used.
2. Dowel Screws (confirmat) are used primarily for assembly. Provided by Corona Millworks.
3. Finished ends can be dowel constructed, or a 3/4" applied finished end can be fabricated from the exterior material. Applied door panels are also available. Corona Millworks will provide inserted hardwood dowels in all horizontal cabinet components for doweled cabinet assembly.
4. Backs are 1/4" thick and dadoed on the sides and bottom of the cabinet. Stop dadoes are used on wall-hung cabinet sides.
5. Drawer stretchers are placed relative to the size and location of the drawer front.
6. Nailers are placed behind the back and are cut from off-fall material. Color may vary.
7. Construction methods may vary for customers' specific requests and option fees will apply.

HARDWARE HOLE LAYOUT METHODS

CNC Machining System

All hardware holes are accurately machined. Holes are placed specifically for each hinge plate, drawer slide, and adjustable shelves.

Holes required for hinge baseplates are placed relative to the top and bottom of the door. Hinge cups can be bored 3" from the top and bottom edge of the door.

Drawer hardware holes are placed for the specified hardware and relative to location of the drawer.

Adjustable shelf holes are placed between the base plates only if adjustable shelves are specified in the cabinet.

Specify exactly which hardware applications are to be used when placing order. Only hardware called out on the order form will fit on the final machined part.

CNC MACHINING CENTER SYSTEM

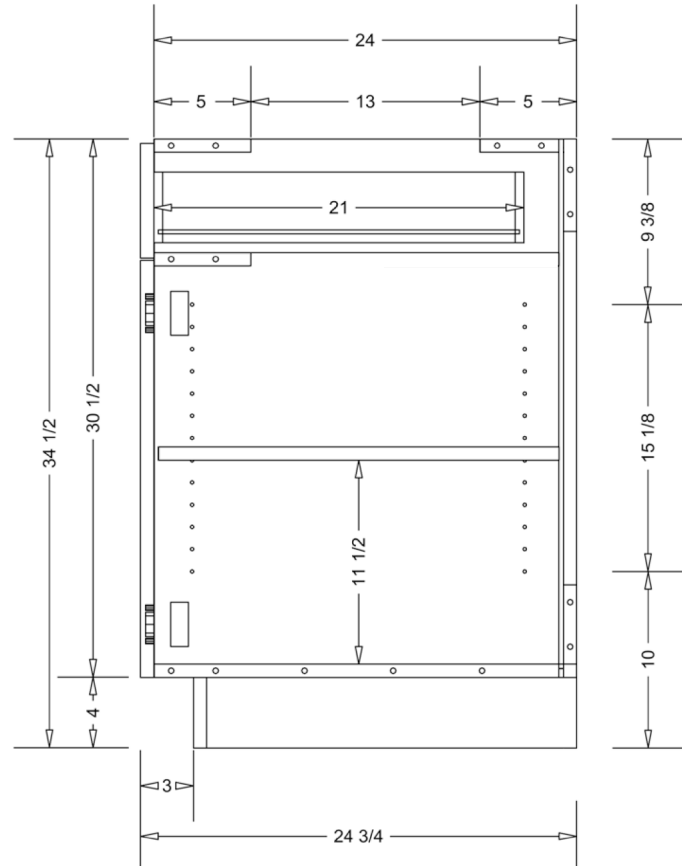

CABINETRY DETAIL ILLUSTRATED

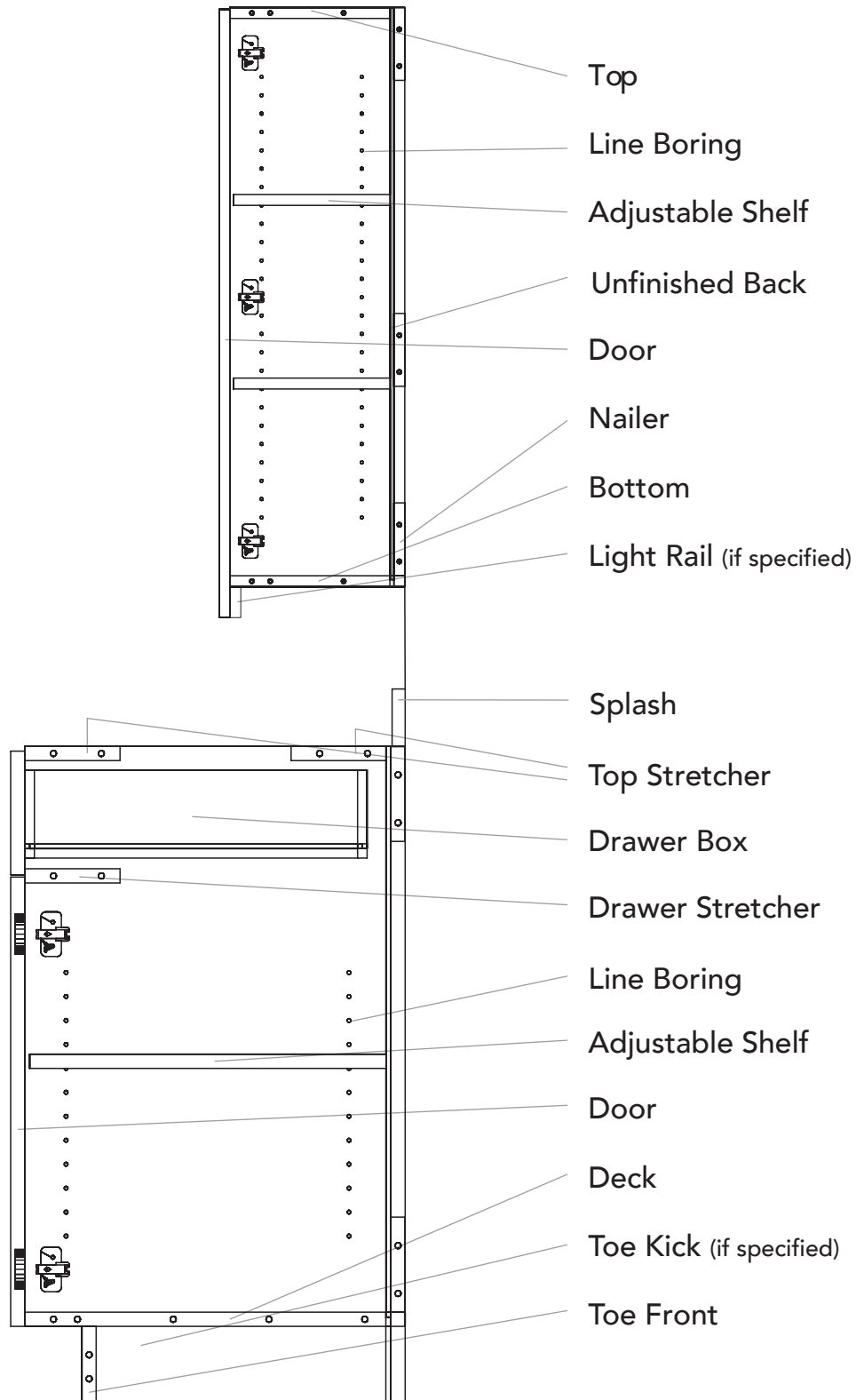

Corona Millworks can construct the cabinet to meet all Woodwork Institute construction standards. It is the responsibility of the customer to specify correct materials, to meet specific grade requirements, and to certify Woodwork Institute compliance.

COMPONENTS & PARTS

100 SERIES - Base Cabinets

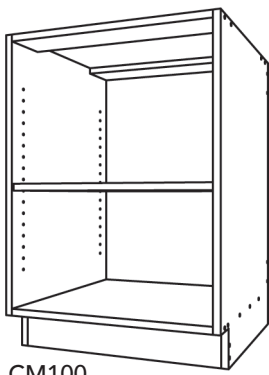

CM100

Open Base Cabinet

- Specify type and number of shelves on order form
- Interior surface shall be as listed on order form unless noted differently

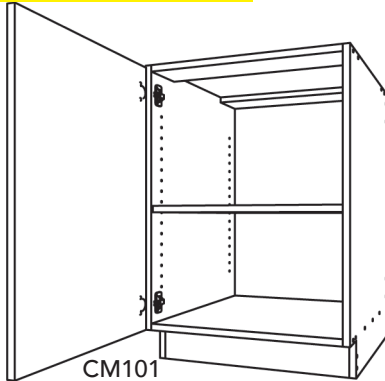

CM101

One-Door Base Cabinet

- Specify type and number of shelves on order form

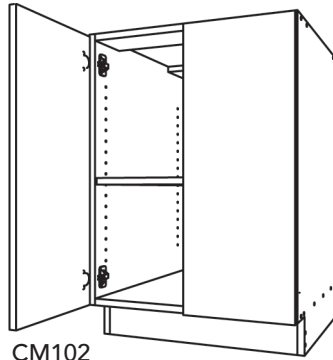

CM102

Two-Door Base Cabinet

- Specify type and number of shelves on order form

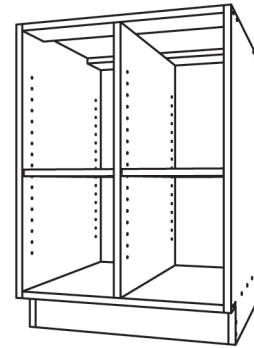

CM110

Open Base Cabinet - One Vertical Divider

- Specify type and number of shelves per opening on order form
- Interior surface shall be as listed on order form unless noted differently

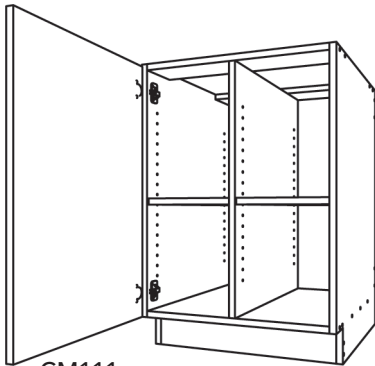

CM111

One-Door Base Cabinet - One Vertical Divider

- Specify type and number of shelves per opening on order form

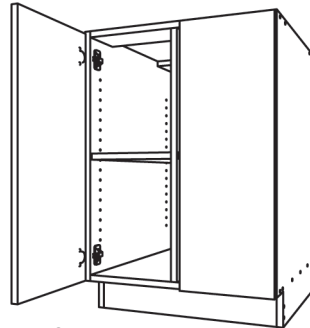

CM112

Two-Door Base Cabinet - One Vertical Divider

- Specify type and number of shelves per opening on order form

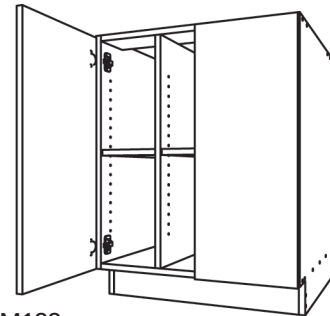

CM122

Two-Door Base Cabinet - Two Vertical Dividers

- Specify type and number of shelves per opening on order form

140 SERIES - Base Cabinets

Cabinet with 4 1/2" apron inset in cabinet.

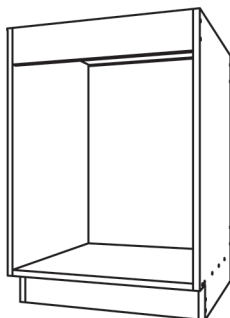

CM140

Open Base Cabinet

- 4 1/2" Apron
- Interior surface shall be as listed on order form unless noted differently

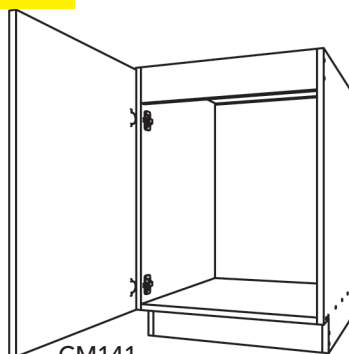

CM141

One Door Base Cabinet

- 4 1/2" Apron behind door

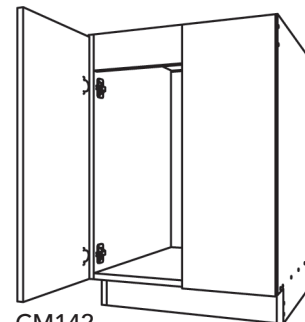

CM142

Two Door Base Cabinet

- 4 1/2" Apron behind door

COMPONENTS & PARTS

100 SERIES - Base Cabinets

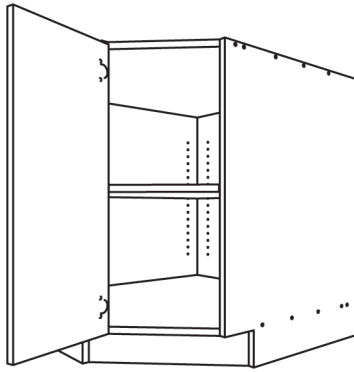

CM186

Two-Door at 45° Angle Corner Base Cabinet

- Specify type and number of shelves on order form
- * Note: Constructed with 3/4" back

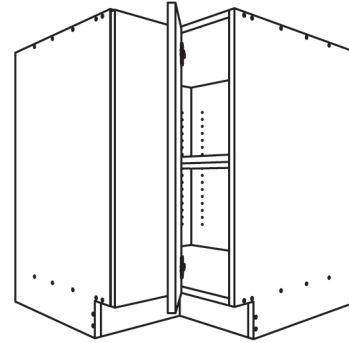

CM197

Two-Door Corner Base Cabinet

- Doors are hinged left or right and bi-fold in the center
- Lazy Susan - must specify diameter and material

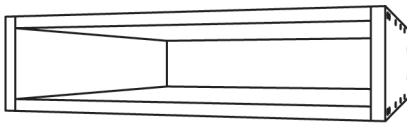

CM190

Storage Apron

- Interior surface shall be as listed on order form unless noted differently

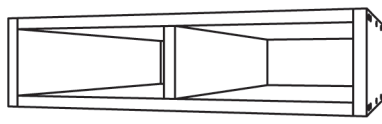

CM191

Storage Apron - One Vertical Divider

- Two equal openings
- Interior surface shall be as listed on order form unless noted differently

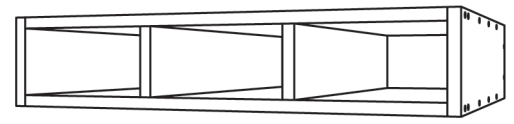

CM192

Storage Apron - Two Vertical Dividers

- Three equal openings
- Interior surface shall be as listed on order form unless noted differently

Sink cabinet with false drawer front. No top stretchers and a vertical false front backer is placed behind the false front.

150 SERIES - Base Cabinets

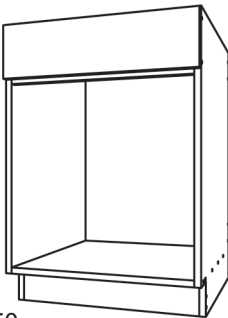

CM150

Open Base Cabinet - False Front

- Specify false front height
- Interior surface shall be as listed on order form unless noted differently
- Apron behind FF and hangs 1" lower

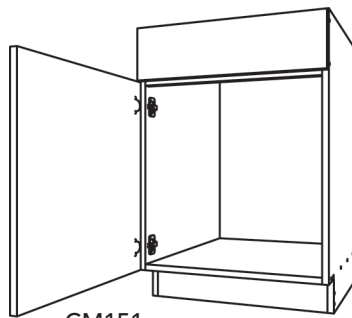

CM151

One-Door Base Cabinet - False Front

- Specify false front height
- Apron behind FF and hangs 1/2" lower

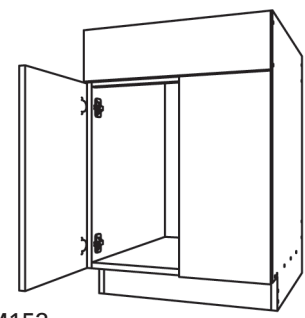

CM152

Two-Door Base Cabinet - False Front

- Specify false front height
- Apron behind FF and hangs 1/2" lower

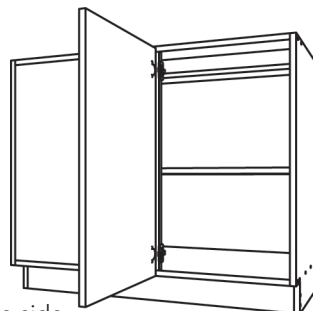

CM176

One-Door Corner Base Cabinet - False Panel

- Specify type and number of shelves on order form
- Specify width of false front panel
- Specify hinge right or left for false panel on opposite side

Note: Hinged on false panel with face frame hinges.

- Lazy Susan hardware is not included unless specified on order form.
- Specify left or right side, width and height dimensions for return panel.

COMPONENTS & PARTS

200 SERIES - Base Cabinets with Drawers

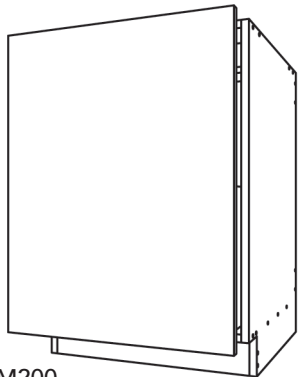

CM200

One-Drawer Base Cabinet

- Full height drawer

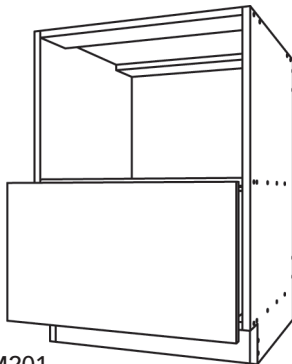

CM201

One-Drawer Open Base Cabinet

- Specify opening height
- Interior surface shall be as listed on order form unless noted differently

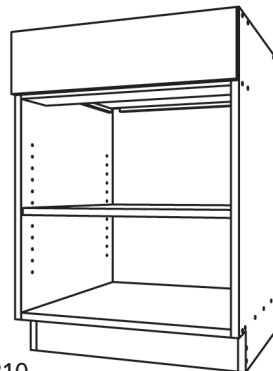

CM210

One-Drawer Open Base Cabinet

- Specify opening height
- Interior surface shall be as listed on order form unless noted differently

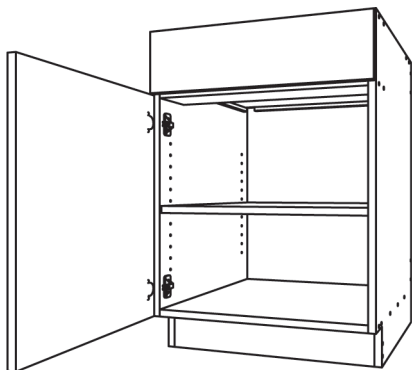

CM211

One-Drawer Open Base Cabinet

- Specify opening height
- Interior surface shall be as listed on order form unless noted differently

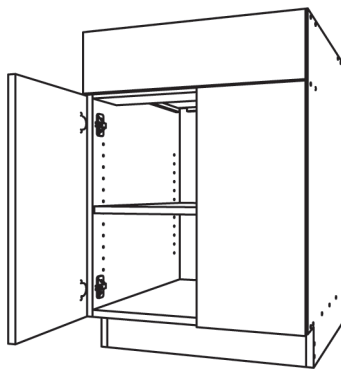

CM212

Two-Door Base Cabinet

- One Wide Drawer
- Specify type and number of shelves on order form

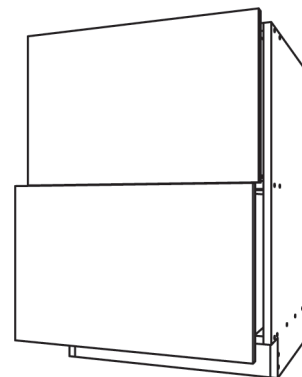

CM220

Two-Drawer Base Cabinet

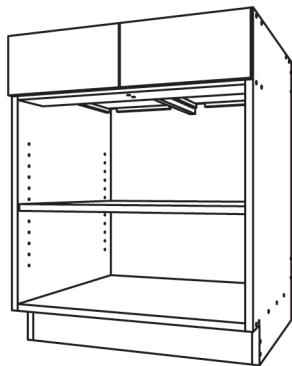

CM221

Open Wide Base Cabinet - Two-Drawer

- Specify type and number of shelves per opening on order form
- Interior surface shall be as listed on order form unless noted differently
- Comes standard with vertical drawer partitions

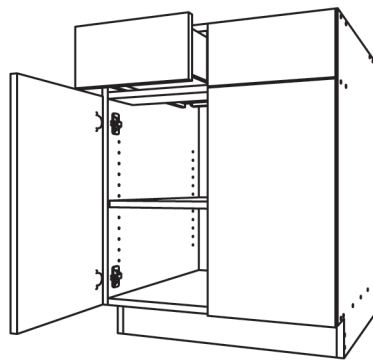

CM222

Two-Door Base Cabinet - Two-Drawer

- Specify type and number of shelves per opening on order form

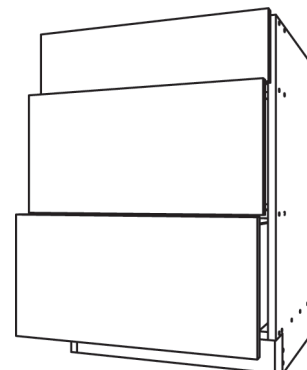

CM230

Three-Drawer Base Cabinet

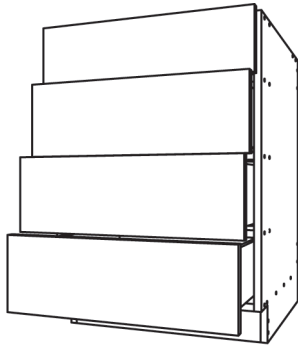

CM240
Four-Drawer Base Cabinet

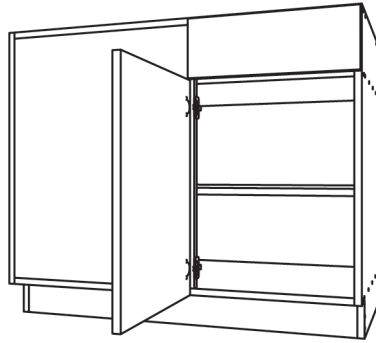

CM276
One-Door Corner Base Cabinet - One Drawer

- Specify type and number of shelves on order form
- Specify width of false front panel

Note: Hinged on false panel with face frame hinges.

- Specify drawer front heights.
- Door and drawer fronts must equal the height of cabinet including the top and bottom reveals with 1/8" (3mm) gap between drawers.

Built with no bottoms.

200 SERIES - Drawer Aprons

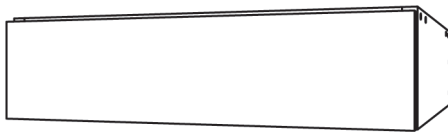

CM290
One-Drawer Apron

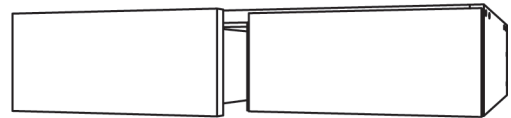

CM291
Two Equal-Drawer Apron

Wall cabinets made of interior material unless specified.

300 SERIES - Upper Cabinets

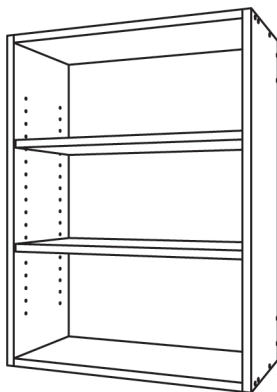

CM300
Open Upper Cabinet

- Specify type and number of shelves on order form
- Interior surface shall be as listed on order form unless noted differently

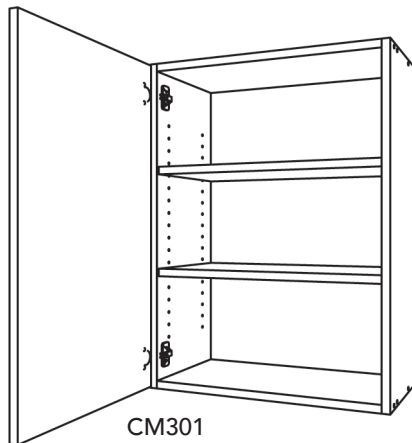

CM301
One-Door Upper Cabinet

- Specify type and number of shelves on order form

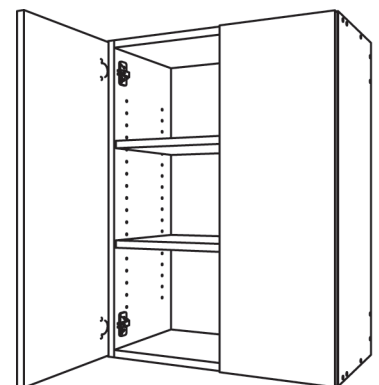

CM302
Two-Door Upper Cabinet

- Specify type and number of shelves on order form
- Interior surface shall be as listed on order form unless noted differently

COMPONENTS & PARTS

300 SERIES - Upper Cabinets

Wall cabinets made of interior material unless specified.

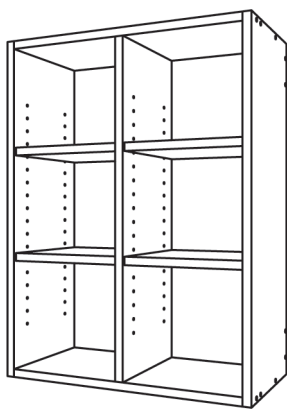

CM310

Open Upper Cabinet

- One vertical divider
- Specify type and number of shelves per opening on order form
- Interior surface shall be listed on order form unless noted differently

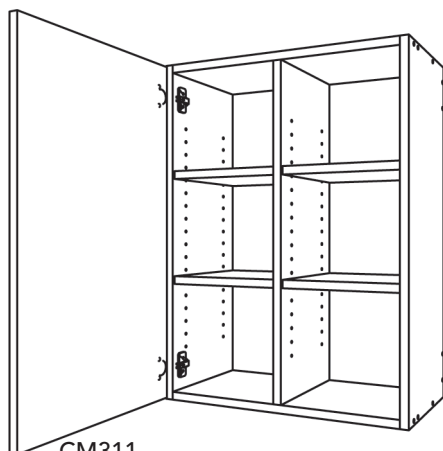

CM311

One-Door Upper Cabinet

- One vertical divider
- Specify type and number of shelves per opening on order form

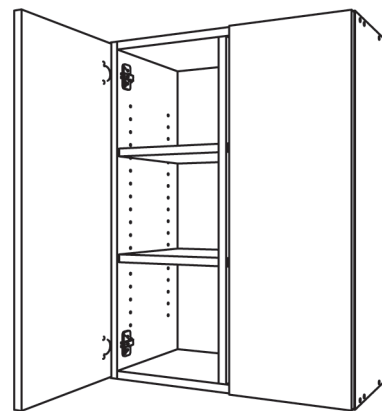

CM312

Two-Door Upper Cabinet

- One vertical divider
- Specify type and number of shelves per opening on order form

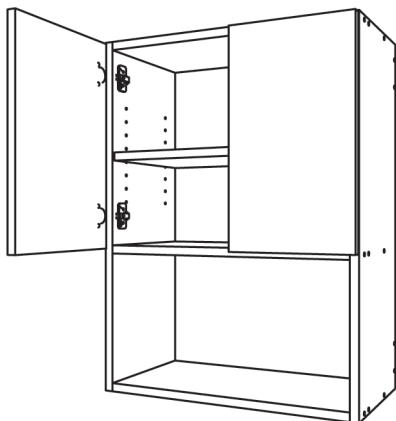

CM326

Partial Open Upper Cabinet - Two Doors

- Specify inside clear height of bottom opening

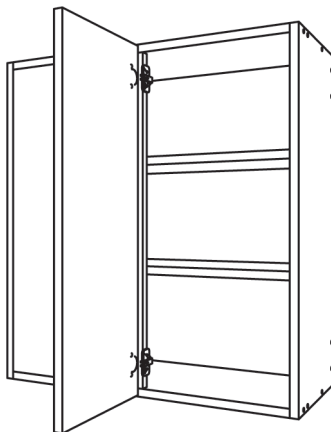

CM376 (Blind Corner 1)

One-Door Corner Upper Cabinet with False Panel

- Specify type and number of shelves per opening on order form
- Specify width of false panel
- Specify hinge right or left for false panel on opposite side

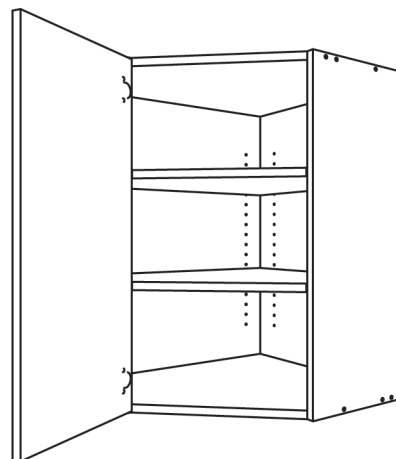

CM386 (Angle Corner 2)

One-Door at 45° Angle Corner Upper Cabinet

- Specify type and number of shelves per opening on order form

- Corner cabinets are constructed with 3/4" backs.

(L-Shaped 2) **CM397**

Two-Door Upper Corner Cabinet

- Doors are hinged left or right
- and bi-fold in the center
- Specify type and number of shelves on order form

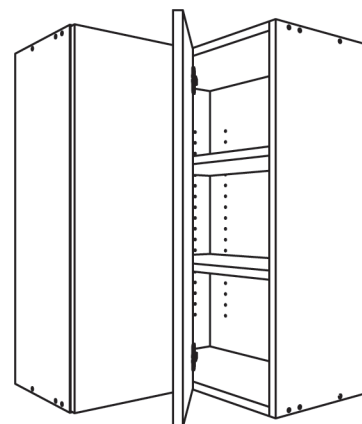

COMPONENTS & PARTS

400 SERIES - Tall Cabinets

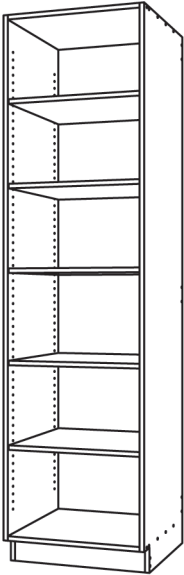

CM400

Open Tall Cabinet

- Specify type and number of shelves on order form
- Interior surface shall be as listed on order form unless noted differently

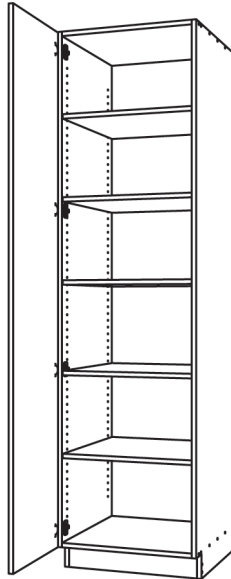

CM401

Open-Door Tall Cabinet

- Specify type and number of shelves on order form

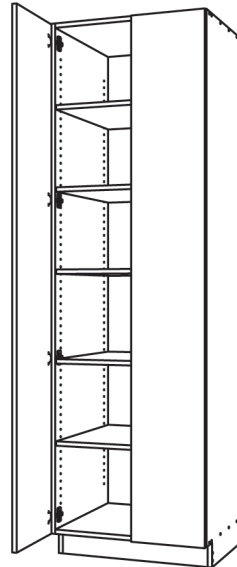

CM402

Two-Door Tall Cabinet

- Specify type and number of shelves on order form

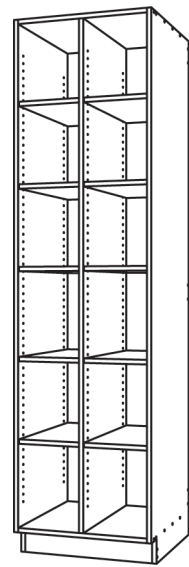

CM410

Open Tall Cabinet

- Open vertical divider
- Specify type and number of shelves on order form
- Interior surface shall be as listed on order form unless noted differently

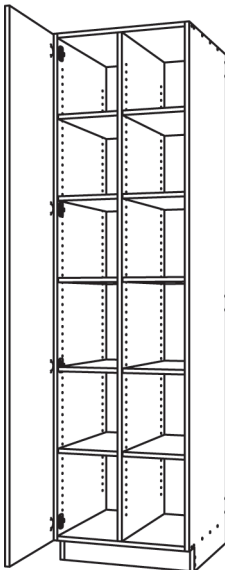

CM411

One-Door Tall Cabinet

- One vertical divider
- Specify type and number of shelves on order form

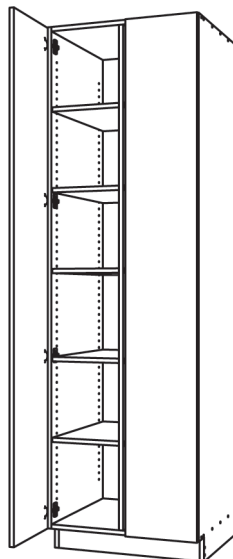

CM412

Two-Door Tall Cabinet

- One vertical divider
- Specify type and number of shelves on order form

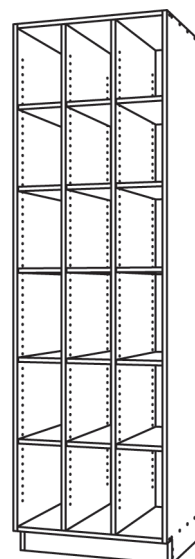

CM420

Open Tall Cabinet

- Two vertical dividers
- Specify type and number of shelves on order form
- Interior surface shall be as listed on order form unless noted differently

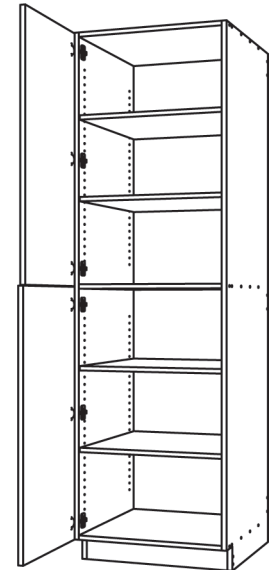

CM423

Two-Door Tall Cabinet

- Specify type and number of shelves on order form
- Specify inside clear opening height on top section

COMPONENTS & PARTS

400 SERIES - Tall Cabinets

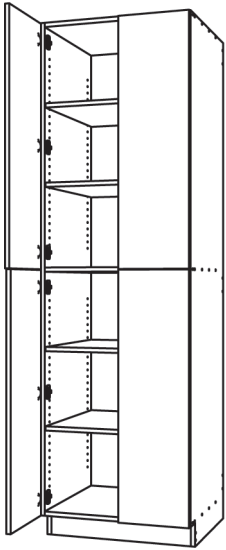

CM424
Tall Cabinet - Four Doors
- Split Height

- Specify door heights
- Specify type and number of shelves on order form

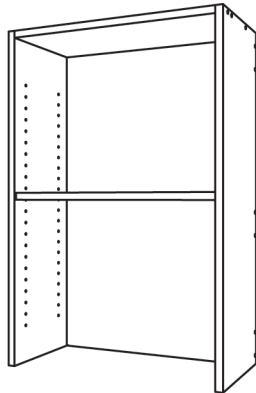

CM440
Open Hutch Cabinet

- Specify number of adjustable shelves
- Interior surface shall be as listed on order form unless noted differently

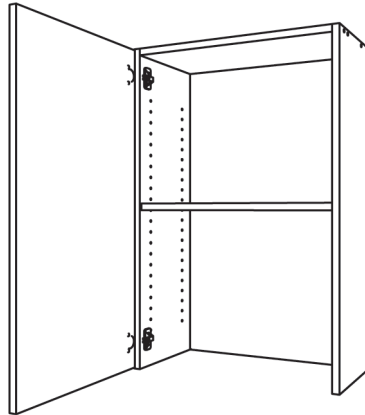

CM441
One-Door Hutch Cabinet

- Specify number of adjustable shelves
- Interior surface shall be as listed on order form unless noted differently

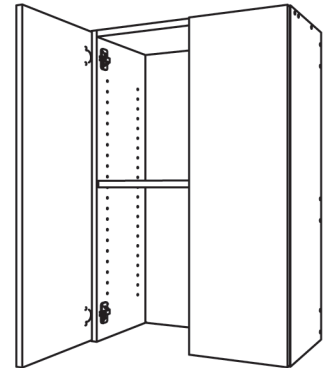

CM442
Two-Door Hutch Cabinet

- Specify number of adjustable shelves
- Interior surface shall be as listed on order form unless noted differently

800 SERIES - Tall Cabinets

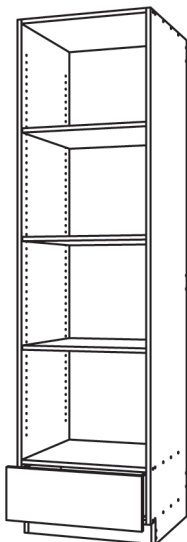

CM810
Open Tall Cabinet - One Drawer

- One Fixed shelf standard
- Specify drawer front height
- Specify number of adjustable shelves
- Interior surface shall be as listed on order form unless noted differently

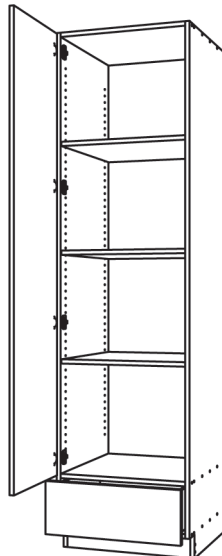

CM811
One-Door Tall Cabinet - One Drawer

- One fixed shelf standard
- Specify drawer front height
- Specify number of adjustable shelves

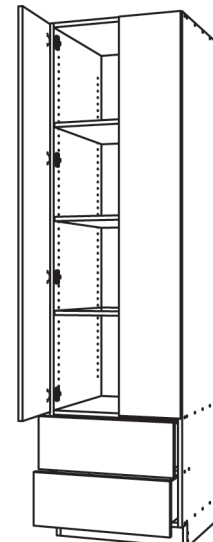

CM820
Two-Door Tall Cabinet - Two Drawers

- 1 Fixed shelf standard
- Specify drawer front heights
- Specify number of adjustable shelves

Specialty Cabinets

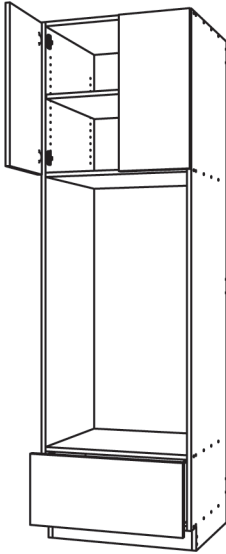

CM812 - O

Tall Cabinet for Oven -
Two Doors

- Specify height for drawer front
- Specify inside clear opening height
- Specify type and number of shelves on order form

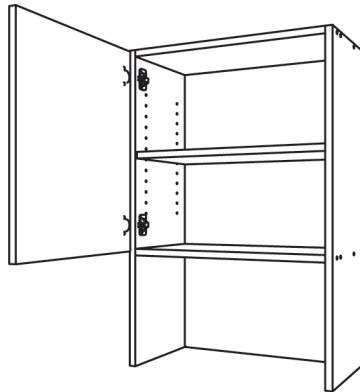

CM441 - O

One Opening Hutch Cabinet -
One Door

- One fixed shelf standard
- Specify opening height
- Specify number of adjustable shelves
- Interior surface shall be as listed on order form unless noted differently

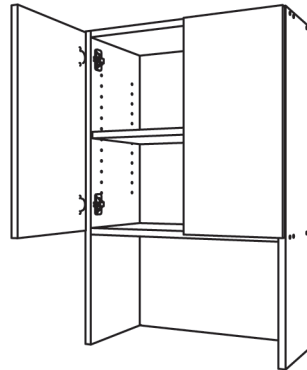

CM442 - O

Two-Door Hutch Cabinet

- One fixed shelf standard
- Specify opening height
- Specify number of adjustable shelves
- Interior surface shall be as listed on order form unless noted differently

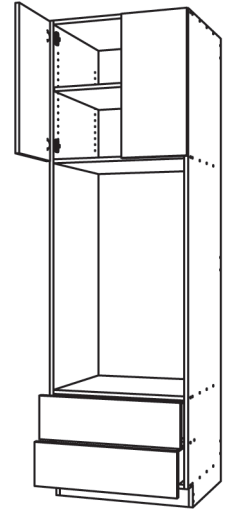

CM822 - O

Two-Door Open Tall Cabinet -
Two Drawers

- Two fixed shelf standard
- Specify drawer box and opening heights
- Specify number of adjustable shelves
- Interior surface shall be as listed on order form unless noted differently

- S (Split Doors): Give the inside height dimensions of the bottom section.
- HP (Horizontal Partition): Give the inside height dimensions of the bottom section.
- D (Drawer Section): Specify drawer front heights.
- O (Open Appliance Section): Specify inside dimensions for each section.

Specialty Parts

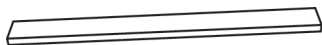

CM910

Base Filler

- Specify width and length



CM930

Upper Filler

- Specify width and length



CM940

Tall Filler

- Specify width and length

FACE FRAMES

FACE FRAME CONSTRUCTION

Butt Joint: Frames will be assembled using wood glue and high-strength pocket screws at all joints

Haunched: For added rigidity, haunched construction may be requested.

- If haunching is requested, all mid-stiles/mid rails will be 1-7/8" wide.
- Haunching will be used for all beaded frames.

Frames can be delivered unassembled, if preferred.

Haunch Construction

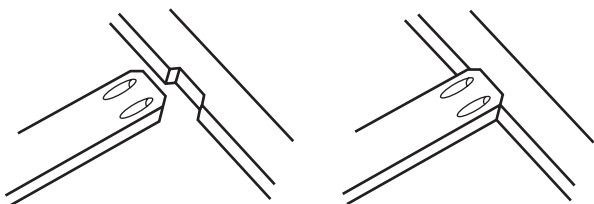

Bead Options

Square



Beaded

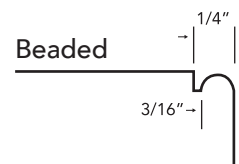

PART WIDTHS

Standard Stile/Rail Widths:

1-1/2", 2", 2-1/2", 3"

Haunched Mid Stile/Rail"

1-7/8"

For standard pricing, stile and rail widths must adhere to stated increments.

Option charges will apply to custom width requests.

MIN / MAX SIZES

For standard pricing, stile and rail widths must adhere to stated increments.

Option charges will apply to custom width requests.

MATERIALS

Corona Millworks offers face frames in Alder, Beech, Cherry, Poplar, Red Oak, Select Maple, Soft Maple, Walnut, and White Oak. Additional varieties can be requested, but availability may affect cost and lead time.

SANDING

All frames will be sanded on the face and back to 13/16".

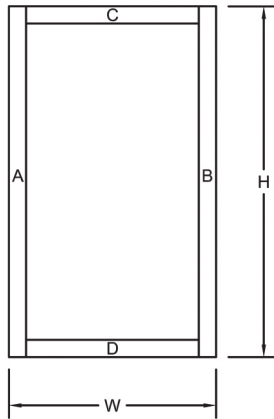

CMF-01

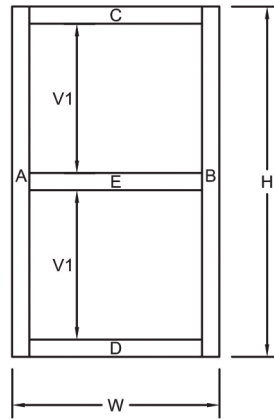

CMF-02

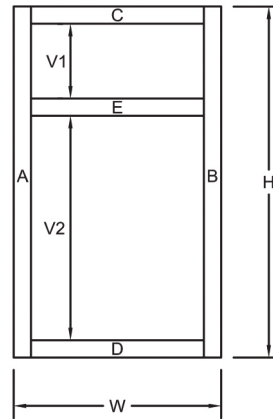

CMF-03

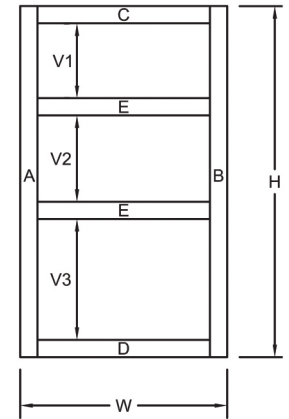

CMF-04

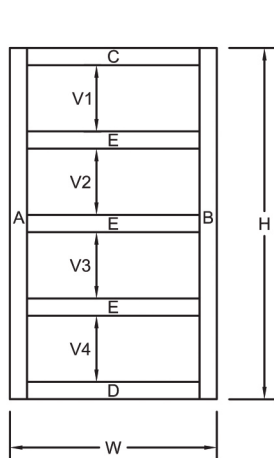

CMF-05

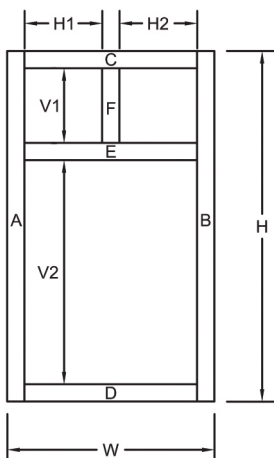

CMF-06

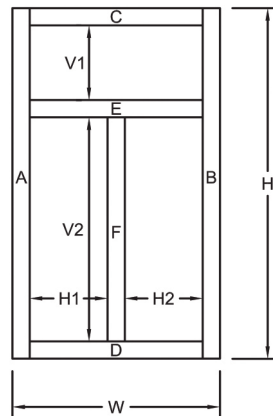

CMF-07

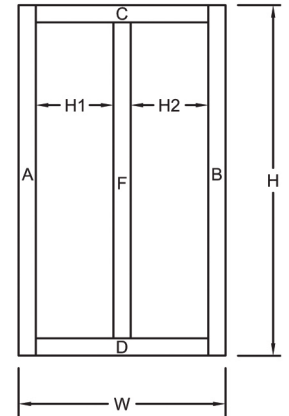

CMF-08

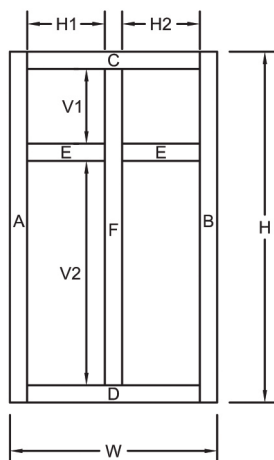

CMF-09

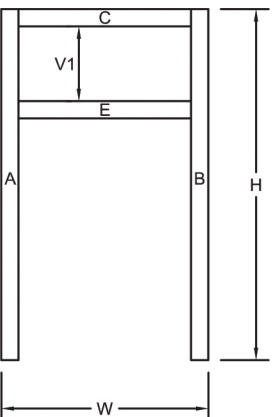

CMF-10

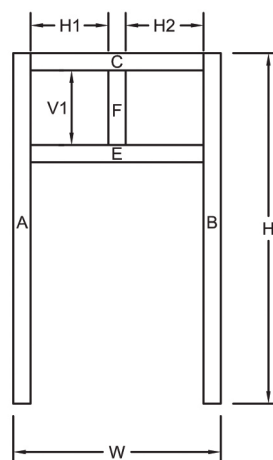

CMF-11



CMF-S
Custom Options Available



Wood Doors | Thermofoil Doors | Drawer Boxes
Cabinet Components | Hardware & More

CONTACT SALES
800-200-0975

FAX
909-606-3270

OFFICE
909-606-3288

ORDER ONLINE
CoronaMillworks.com

**CATALOG EXCERPT FROM MASTER
VOLUME #2017-1**